

Clear Hole

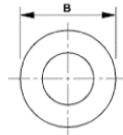

Type: CH

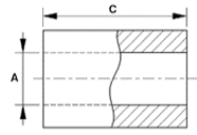

CH

Lengths

2-3-4-5-8-10-12-15-18-20-25-30-35-40-45-50-55-60

For special lengths, please contact our sales dept.

Material Code

B = brass nickel plated

S = mild steel zinc plated

SS = stainless steel

How to order

Type + Inside Dia. + Outer Dia. + Length + Material Code

Example: CH-22-40-8-B or CH-32-60-12-SS

A Inside Dia. mm	B Outer Dia. mm	C Length mm		Please note!
		Min.	Max.	
2.2	4.0	2	30	Can be customized
2.5	5.0	2	30	Can be customized
3.2	6.0	2	60	Can be customized
4.3	8.0	2	60	Can be customized
5.3	10.0	2	50	Can be customized

