

Heavy Duty

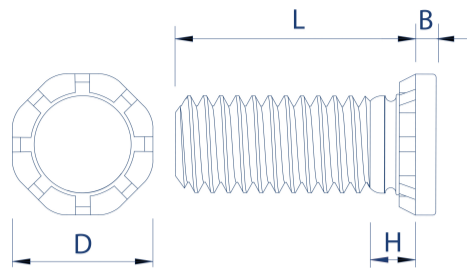

Type: SF-HFH or SF-HFHS

SF-HFH/SF-HFHS

Material Code

Steel/zinc = SF-HFH

Stainless steel = SF-HFHS

How to order

Type + Thread + Length

Example: SF-HFH-M5-15 or SF-HFHS-M8-20

Thread	B max. mm	D ± 0.25 mm	H max. mm	L ±0.4 mm	Sheet Thickness min. mm	Rec. Hole Size +0.13 mm	Distance Centre Hole to Sheet Edge min. mm	Please note!
M5	2.7	7.8	1.14	15	1.3	5.0	10.7	
M6	2.8	9.4	1.27	15/20/25/30/40	1.5	6.0	11.5	
M8	3.5	12.5	1.78	15/20/25/30/35/40	2.0	8.0	12.7	
M10	4.1	15.7	2.29	15/20/25/30/35/40	2,3	10.0	13.7	

